



DEPARTMENT OF THE NAVY
JOINT BASE PEARL HARBOR-HICKAM
850 TICONDEROGA ST STE 100
PEARL HARBOR HI 96860-5102

5090
Ser JB4/1043
28 Sep 2020

From: Commander, Joint Base Pearl Harbor-Hickam
To: Staff and Patrons of Joint Base Pearl Harbor-Hickam Catlin School-Age Care (Building 4655H)

Subj: SAMPLING AND TESTING FOR LEAD IN DRINKING WATER AT CATLIN SCHOOL-AGE CARE

Ref: (a) OPNAVINST 5090.1E, Environmental Readiness Program

Encl: (1) Overview of Testing Results and Corrective Actions for Catlin SAC (Building 4655H)

1. I am pleased to report that all water intended for consumption at this Youth Center (YC) has tested below the Environmental Protection Agency's (EPA's) lead screening level of 15 parts per billion (ppb). Initial results identified that one outlet at Catlin School-Age Care (SAC) did not meet EPA's lead screening level. Shortly after receiving the initial results, we took the outlet out of service and performed corrective actions. Follow-up sampling identified that the outlet at Catlin SAC is now compliant with EPA's lead screening level and no further action is required. Enclosure 1 of this letter provides a summary of all sampling results for the entire facility.

2. These tests are conducted every 5 years, and samples are taken from all sources water used for drinking, cooking, or washing at all YCs and Child Development Centers (CDCs). Our latest tests were conducted in December 2019.

3. Per reference (a), we have adopted the EPA's recommendation that we test the lead content of drinking water in priority areas such as YCs and CDCs as policy and made this a top priority. Our environmental personnel conducted this testing following Navy and EPA guidelines, and samples were sent to a state-certified or accredited laboratory for analysis.

4. My team and I will continue to monitor and test water quality at all of our YCs and CDCs to ensure our water is safe to drink and use. I remain committed to the safety and health of all personnel and family members using our facilities and will keep you updated as necessary.

5. If you have questions regarding the sampling program, please contact our Installation Environmental Program Director at (808) 474-0392 or steven.christiansen@navy.mil.

R. E. HARMEYER
CAPT, CEC, U.S. Navy
By direction

Copy:
CNIC N45
CNRH N45
NAVFAC HI EV, EV1, PRJ4

Overview of Testing Results and Corrective Actions for Catlin SAC (Building 4655)

At the Catlin SAC, outlets used for drinking, cooking, and washing were tested. Out of 17 samples collected, one water outlet initially tested above the screening level of 15 parts per billion (ppb) for lead in drinking water in schools and childcare centers.

The first sampling event took place on November 26, 2019. We received the test results on December 5, 2019 which included one exceedance. We took that outlet out of service shortly after and conducted follow up sampling on December 19, 2019 to verify the result. Summary table of the results from the first and follow-up samples for the one outlet:

Outlet ID#	Outlet Description	First Sample (ppb)	Follow-up Sample (ppb)		Comments and Corrective Actions
			First Draw	Flush	
14	Hose Bibb (exterior of activity room 1)	29	5.2	Not Detected	Most likely source of lead was from infrequent use of the outlet. Water should be run for 30 sec in the morning.

A complete summary results table (enclosure 2) is enclosed for your information. The *Building #* and *Room #* indicate the location of the fixture. The *Outlet Map #* corresponds to the location indicated on the floor plan of the CDC (enclosure 3). The *Category* column gives information about whether the outlet is used for drinking water (water fountain), cooking (food preparation), or washing (primarily hand-washing or brushing teeth). The *Outlet Description* column contains additional information to describe the outlet. The next set of columns provide *Initial Lead Results*, and for those locations that exceeded the recommended screening level of 15 ppb the *Follow-up Lead Results*.

EPA sampling protocol requires water to not be used for between 8 and 18 hours prior to first draw sampling. Therefore, *Initial Lead Results* were from first draw samples collected early in the morning before the CDC opened and before any water was used. The *Initial Lead Results* also indicate whether resampling is required.

The *Follow-up Lead Results* includes columns for *First Draw* and *Flush* samples, which help determine the source of lead:

- If the lead concentration of 30 second flush sample resulted in lower than 15 ppb lead, the aerators were the source of lead and the outlet can be used for drinking if the aerators are cleaned on a regular basis.
- If the lead concentration of the resampled first draw (but not the follow up 30 second flush) was greater than 15 ppb, the fixture was the source of lead. These fixtures can be used if water is flushed for 30 seconds before first use of the day or if the fixtures are replaced and retesting confirms that the new fixtures do not leach lead.
- If the lead concentration of the sample following the 30 second flush was greater than 15 ppb and greater than the lead concentration of the first draw resample, the source of lead is the plumbing upstream of the outlet. These outlets should be disconnected unless upstream plumbing is replaced.

The *Comments* column indicates additional information regarding the fixture and actions to remediate the source of lead if detected.

LIPA Test Results
JBPHH - Catlin SAC (Building # 4655H)

Initial Sample Date: 11/26/19, Results Date: 12/16/19
 Follow-up Sample Date: 12/19/19, Results Date: 01/08/20

Building #	Room #	Outlet Map #	Category	Outlet Description	Initial Lead Results (ppb)	Follow-up Lead Results (ppb)		Comments
						First Draw	Flush	
4655H	Activity Room 1	1	Washing	Adult Sink	Not Detected	Not Sampled	Not Sampled	
4655H	Activity Room 2	2	Washing	Adult Sink	Not Detected	Not Sampled	Not Sampled	
4655H	Activity Room 3	3	Washing	Adult Sink	Not Detected	Not Sampled	Not Sampled	
4655H	Boys Bathroom	4	Washing	Adult Sink	Not Detected	Not Sampled	Not Sampled	
4655H	Boys Bathroom	5	Washing	Adult Sink - Sensor	1.1	Not Sampled	Not Sampled	
4655H	Exterior	14	Washing	Hose Bib	29	5.2	Not Detected	Most likely source of lead was from infrequent use of the sink. Water should be run for 30 sec in the morning
4655H	Exterior	15	Washing	Hose Bib	0.58	Not Sampled	Not Sampled	Used for waterplay
4655H	Exterior	16	Drinking	Portable Water Cooler	Not Detected	Not Sampled	Not Sampled	
4655H	Exterior	17	Washing	Adult Sink	0.72	Not Sampled	Not Sampled	
4655H	Exterior	18	Washing	Adult Sink	1.2	Not Sampled	Not Sampled	
4655H	Game Room	12	Drinking	Water Fountain - Cooler	Not Detected	Not Sampled	Not Sampled	
4655H	Game Room	13	Drinking	Water Fountain - Cooler	Not Detected	Not Sampled	Not Sampled	
4655H	Girls Bathroom	6	Washing	Adult Sink - Sensor	1.6	Not Sampled	Not Sampled	
4655H	Girls Bathroom	7	Washing	Adult Sink - Sensor	1.7	Not Sampled	Not Sampled	
4655H	Kitchen	8	Cooking	Kitchen Sink	Not Detected	Not Sampled	Not Sampled	
4655H	Mens Bathroom	10	Washing	Adult Sink	Not Detected	Not Sampled	Not Sampled	
4655H	Womens Bathroom	11	Washing	Adult Sink	1.1	Not Sampled	Not Sampled	
4655H	Kitchen	9	Drinking	Ice Machine	Not Sampled	Not Sampled	Not Sampled	Fixture removed

TRUE NORTH
NOT TO SCALE

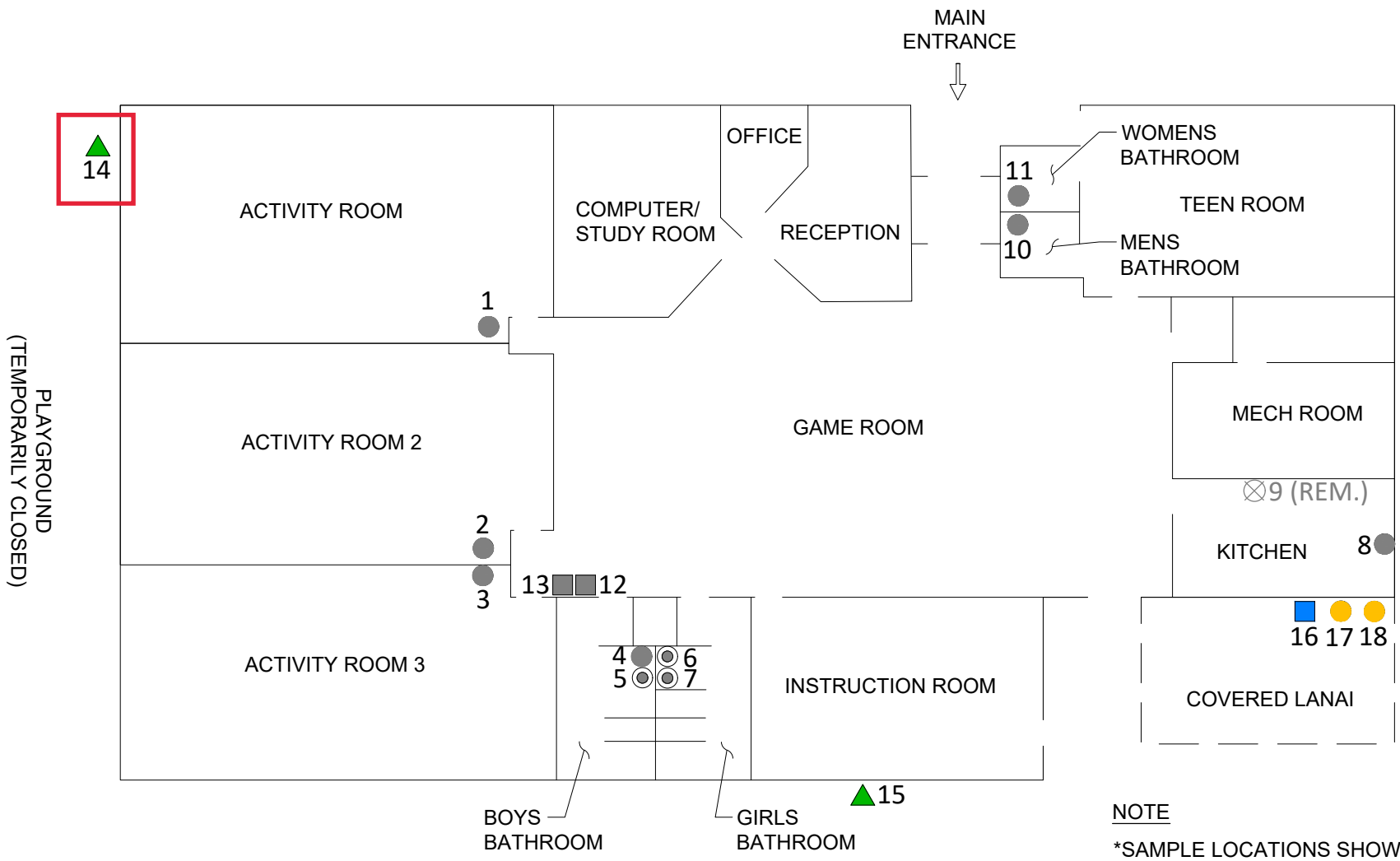

NOTE
*SAMPLE LOCATIONS SHOWN IN GREY HAVE BEEN SAMPLED BY NAVFAC HI IN 2019 AND WILL NOT BE RESAMPLED FOR THIS PROJECT.

LEGEND

- SINK FAUCET*
- SINK FAUCET (SENSOR TYPE)*
- DRINKING FOUNTAIN (COOLER)* AND PORTABLE WATER COOLER
- HOSE BIB
- WATER OUTLET (FIXTURE REMOVED OR NON-CONSUMABLE USE)

Enclosure (3)

	DATE: OCT 2019	PROJECT TITLE: LEAD IN DRINKING WATER TESTING AT PRIORITY AREAS AT JBPHH AND NCTAMS, PACIFIC
	FIGURE TITLE: PEARL HARBOR, CATLIN SAC (BLDG 4655) - SAMPLE LOCATIONS	
		FIGURE NO.: 15